

# Eclipse RatioAir Burners

Model RA2000

Version 1

## Main Specifications - RA2000

PARAMETER		SPECIFICATIONS
Maximum input, Btu/hr (kW) at neutral chamber conditions. (Natural Gas)		20,400,000 (5970)
Minimum input, Btu/hr (kW) • Lower inputs may be achieved. Contact factory.		350,000 (100)
Main Gas Inlet Pressure, "w.c. (mbar) • Fuel pressure at ratio regulator inlet.		30 to 60 (75 to 150)
High Fire Flame Length, inches (mm) • Measured from the outlet end of the combustor.		160 (4000)
Maximum Flame Velocity, ft/s (m/s) • Approximately 15% excess air at maximum input.		375 (114)
Maximum chamber temperature, °F (°C)	Alloy tube Block & Holder	1750 (950) 2200 (1200)
Flame detection		UV scanner only
Fuel		Natural Gas*

\*For any other gas, contact Eclipse Combustion for orifice sizing.

- All information is based on laboratory testing in neutral (0.0" w.c.) chamber with standard combustor design. Different chamber conditions will affect the data.
- Maximum inputs are given for the standard combustion air blower without an air filter.
- All inputs based upon gross calorific values and standard conditions: 1 atmosphere, 70° F ( 21°C).
- Blower motor service factors greater than 1.0 may be required when firing into negative chamber pressure applications. For specific application questions, contact your Eclipse Combustion representative.
- Eclipse reserves the right to change the construction and/or configuration of our products at any time without being obliged to adjust earlier supplies accordingly.

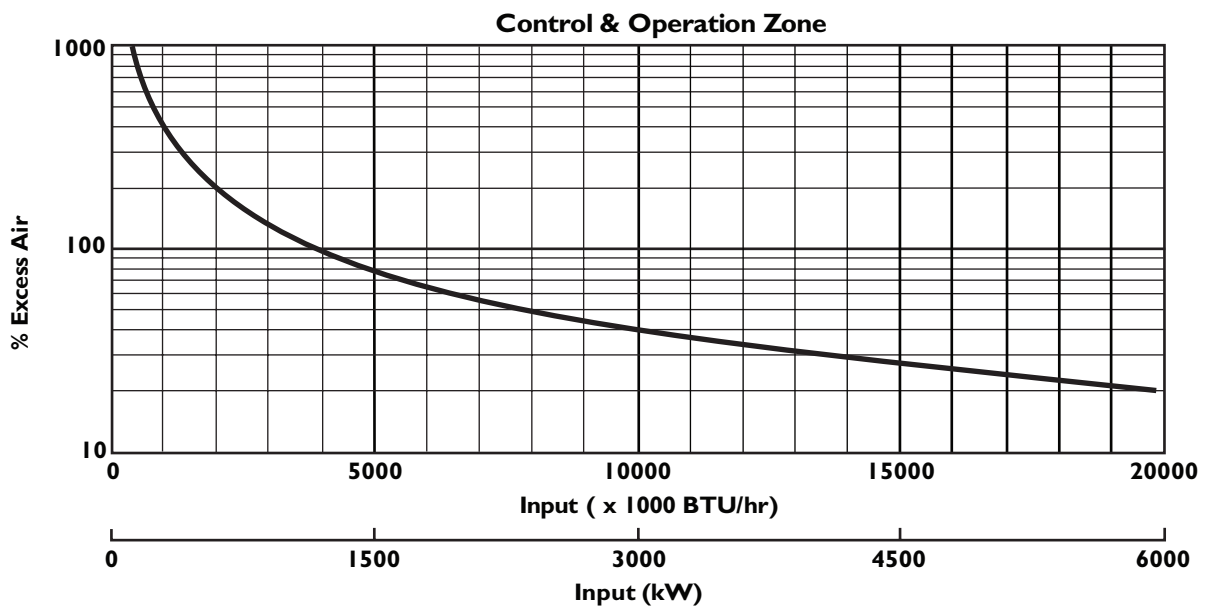

# Medium Velocity Tube

## Blower Model

60Hz, 8D (20" w.c. @250,000 scfh, 30 hp)

Specifications				
Parameter	"w.c.	(mbar)	60Hz Packaged Blower	
			Btu/hr	kW
Maximum Input vs. Chamber Pressure (Natural Gas)	-2.0	-5.0	21,475,000	6288
	-1.0	-2.5	20,950,000	6134
	0.0	0.0	20,400,000	5973
	1.0	2.5	19,840,000	5809
	2.0	5.0	19,250,000	5637

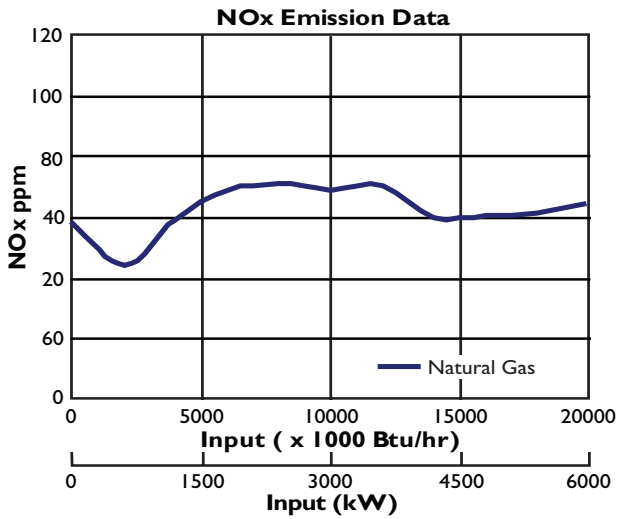

NOx emission data is given for:

- Ambient combustion air ~70°F (20°C)
- Minimal process air velocity
- ppm volume dry at 3% O<sub>2</sub>
- Neutral chamber pressure

CO emission is largely influenced by chamber conditions. Contact your local Eclipse Combustion representative for an estimate of CO emission on your application.

Emissions are influenced by:

- Chamber conditions
- Fuel type
- Firing rate
- Ratio regulator adjustment
- Combustion air temperature

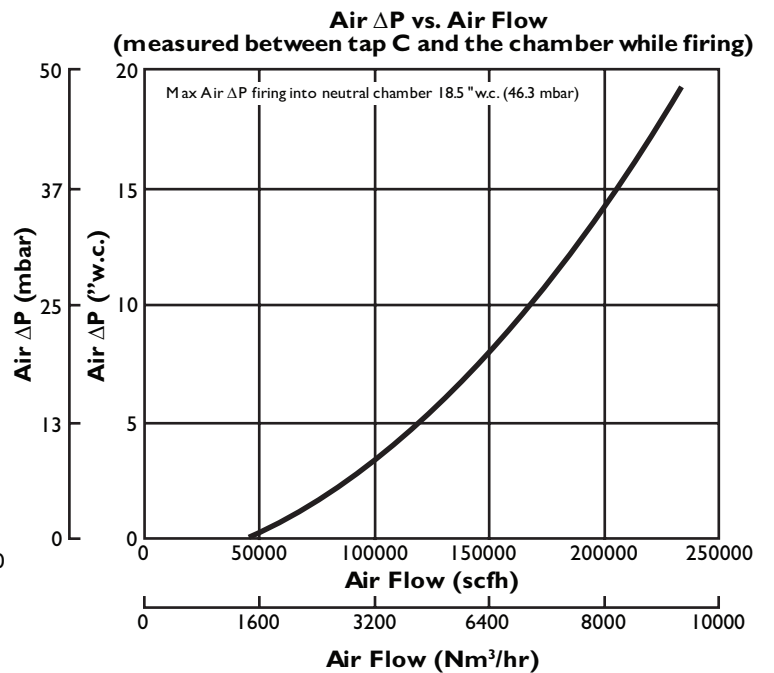
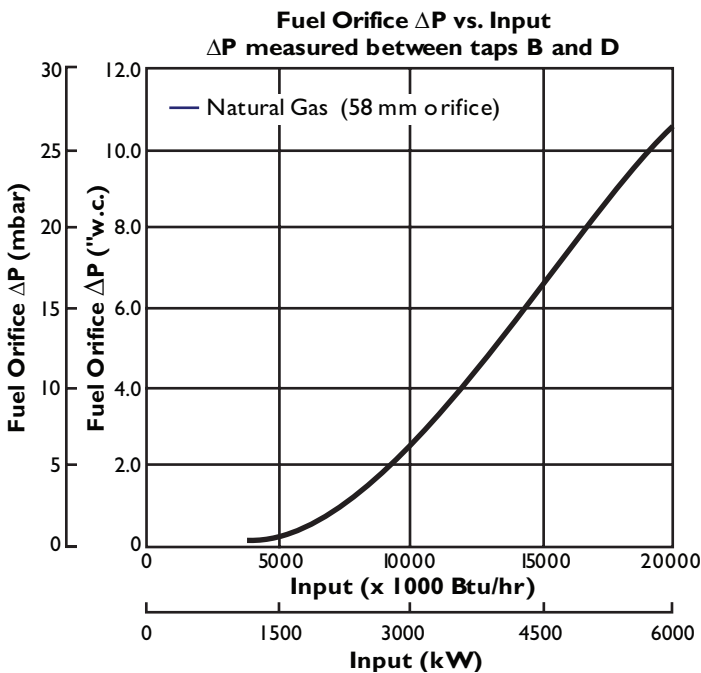

## Dimensions Inches (mm)

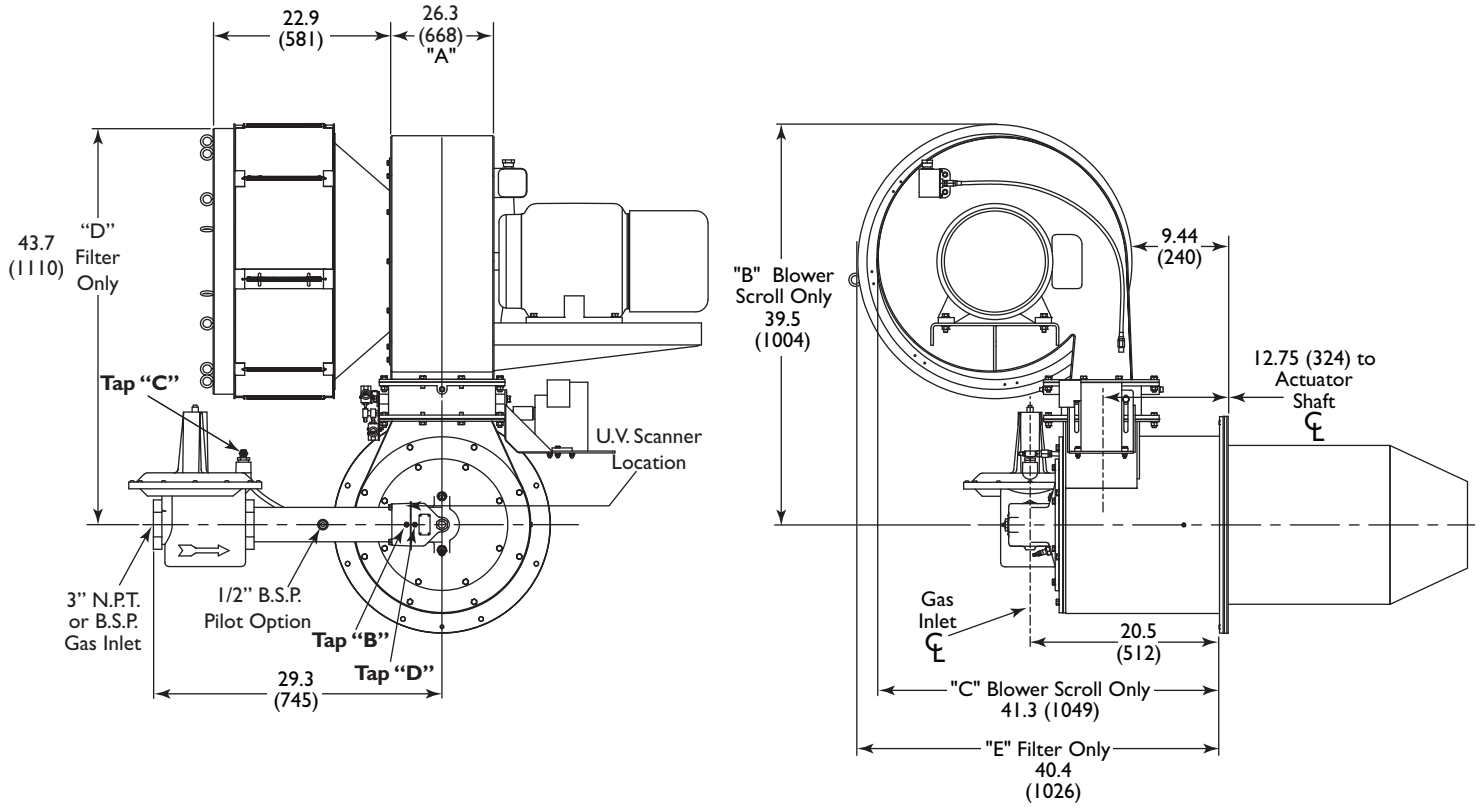

### Combustor

Exhaust outlet diameter : 300mm (11.8")

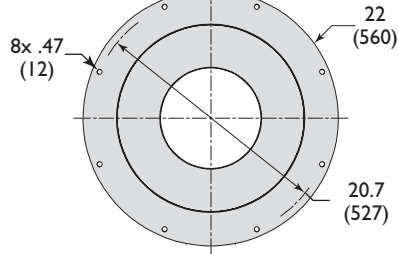
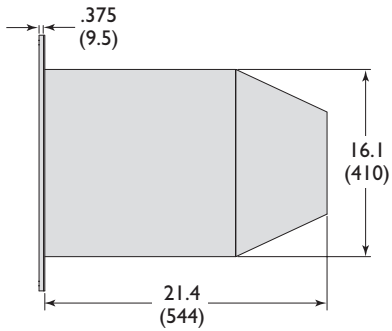

**Alloy Tube (AISI 310)**

Max. Chamber Temp : 1,750°F (950°C)



**Offered By:**

Power Equipment Company  
2011 Williamsburg Road  
Richmond, Virginia 23231  
Phone (804) 236-3800  
Fax (804) 236-3882

---

[www.peconet.com](http://www.peconet.com)